

LUBRICATION CHARTS AND SPECIFICATIONS

GROUP 21

LUBRICATION SPECIFICATIONS

ITEM	FORD PART NO.	PART NAME	FORD SPECIFICATIONS
Body Hinges	C4AZ-19584-A R-138-B	Lifetime Body Grease	ESB-M1C105-A
Brake Master Cylinder	B7AZ-19542-A R-103-A	Rotunda Heavy Duty Brake Fluid	SAE 70R3
Front Suspension Ball Joints and Steering Linkage	C1AZ-19590-B	FoMoCo Ball Joint Grease	M1C75-A
Front Wheel Bearings	C2AZ-19585-A	FoMoCo Wheel Bearing Grease	ESA-M1C60-A
Hood Latch & Safety Catch	C4AZ-19584-A R-138-B	Lifetime Body Grease	ESB-M1C105-A
Lock Cylinders	B4A-19587-A	Rotunda Lock Lubricant	ESB-M2C20-A
Rear Axle (except 390 CID 2V and 4V)	C1AZ-19580-E or F	FoMoCo Hypoid Gear Lube	ESW-M2C50-A
Rear Axle (Hi Performance Engines and 390 CID 2V and 4V)	C2AZ-19580-D	FoMoCo Hypoid Gear Lube	ESW-M2C57-A
Limited Slip Axles (use 4 oz. of additive per axle)	C1AA-19B546-A	Locking Differential Additive	ESW-M2C58-A
Steering Gear Housing (Manual or Power)	C3AZ-19578-A	Lifetime Steering Gear Grease	ESW-M1C87-A
Steering-Power (Pump Reservoir)	C1AZ-19582-A R-106-A	Rotunda Automatic Transmission Fluid	M2C33-D
Convertible Top Reservoir	C1AZ-19582-A R-106-A	Rotunda Automatic Transmission Fluid	M2C33-D
Transmission (Automatic)	C1AZ-19582-A R-106A	Rotunda Automatic Transmission Fluid	M2C33-D
Transmission (Manual Shift)	C3RZ-19C547-B	Rotunda Manual Transmission Lube	ESW-M2C83-A
Universal Joints	C1AZ-19586-B	FoMoCo Universal Lube	ESA-M1C57-A
Engine Crankcase Oil SAE 10W-20W-30 SAE 5W-10W-20 SAE 20W-30-40	C5AZ-19579-A, B or C R-10-A, B or C C5AZ-19579-D, E or F R-10-D, E or F C5AZ-19579-G, H or J R-10-G, H or J	Rotunda Motor Oil (MS Sequence tested SAE 10W-20W-30 above -10°F SAE 5W-10W-20 for substained temperatures below -10°F SAE 20W-30-40 for temperatures above +90°F)	ESE-M2C101-A
Engine Oil Filter	C1AZ-6731-A R1-A	Rotunda Oil Filter—6,000 mile type	

ENGINE CRANKCASE OILS

Use of SAE 10W-30 oil will provide the proper viscosity for all normal ranges of outside temperatures. For operation at sustained outside temperatures below -10° F, a 5W-20 oil should be used.

Oil Quality

Use only oils which have been tested and certified by the maker as satisfying automobile manufacturers specifications for Engine Operating Sequence Tests for Service M.S. The Ford Motor Company specification covering these tests is ESE M2C101-A. These tests are defined

by ASTM committee D2 for Section G-IV of technical committee B and are published in the SAE Handbook.

These tests cover oil characteristics as follows:

Sequence I—Low Temperature Wear Prevention—(Cold Starts)

Sequence II—High-Speed—High Temperature Wear Prevention.

Sequence III—High Temperature Deposit Formation—(Varnish)

Sequence IV—Corrosion and Rust Prevention

Sequence V—Sludge Formation

If engine oils are used which do not meet these requirements, it will be necessary to change oil more frequently than every 6,000 miles.

If it is necessary to use an "MS" oil which is not certified by the marketer as having passed the Engine Operating Sequence Tests, the addition of Rotunda Oil Conditioner to the oil will satisfy the requirements. Rotunda 6,000 Mile Motor Oil meets these requirements.

Oil Filter

Use of the right oil filter is also essential to good engine life and operation. For 6,000-mile filter change intervals, filters must meet Ford Specification ES-COAE-6714-A.

The Genuine Rotunda Oil Filter meets this requirement.

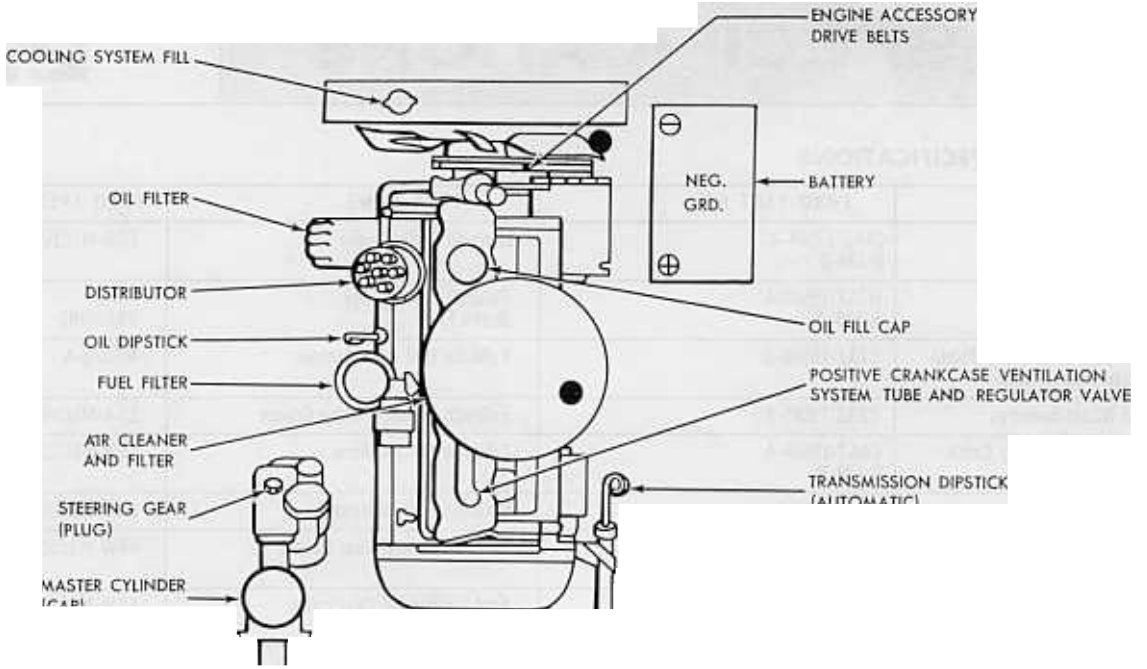

● COOLING SYSTEM DRAIN

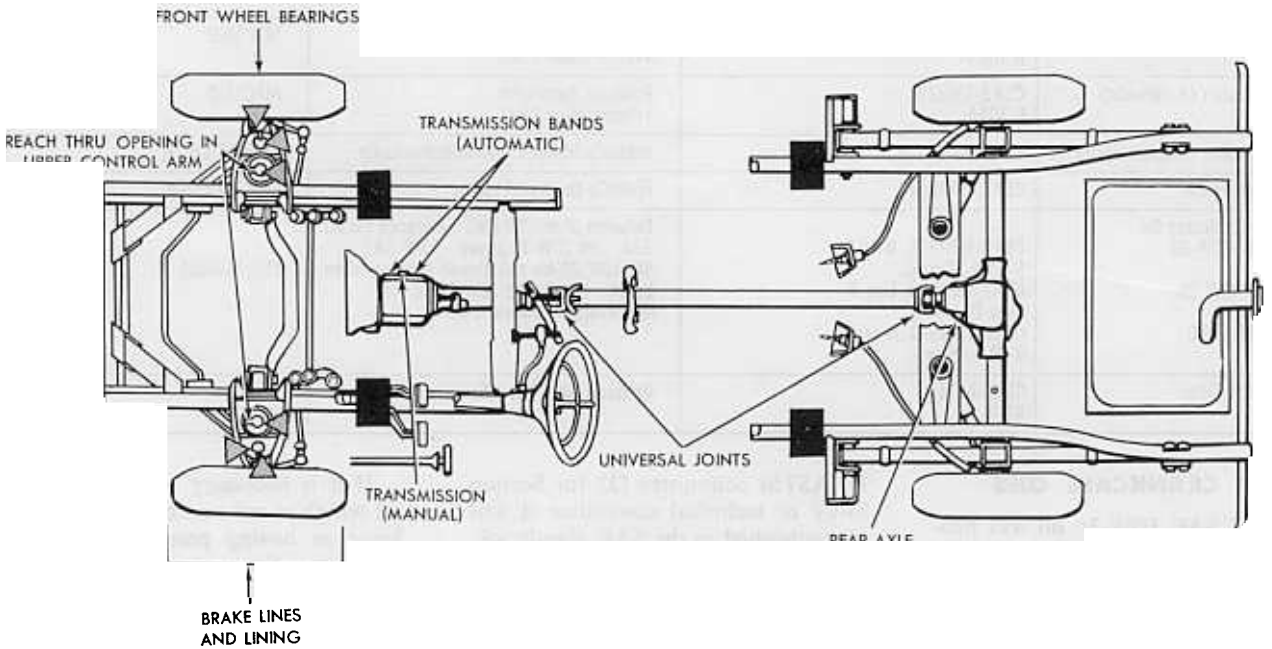

▲ FRONT SUSPENSION

FIG. 1 Typical Lubrication Chart—6-Cylinder Engine

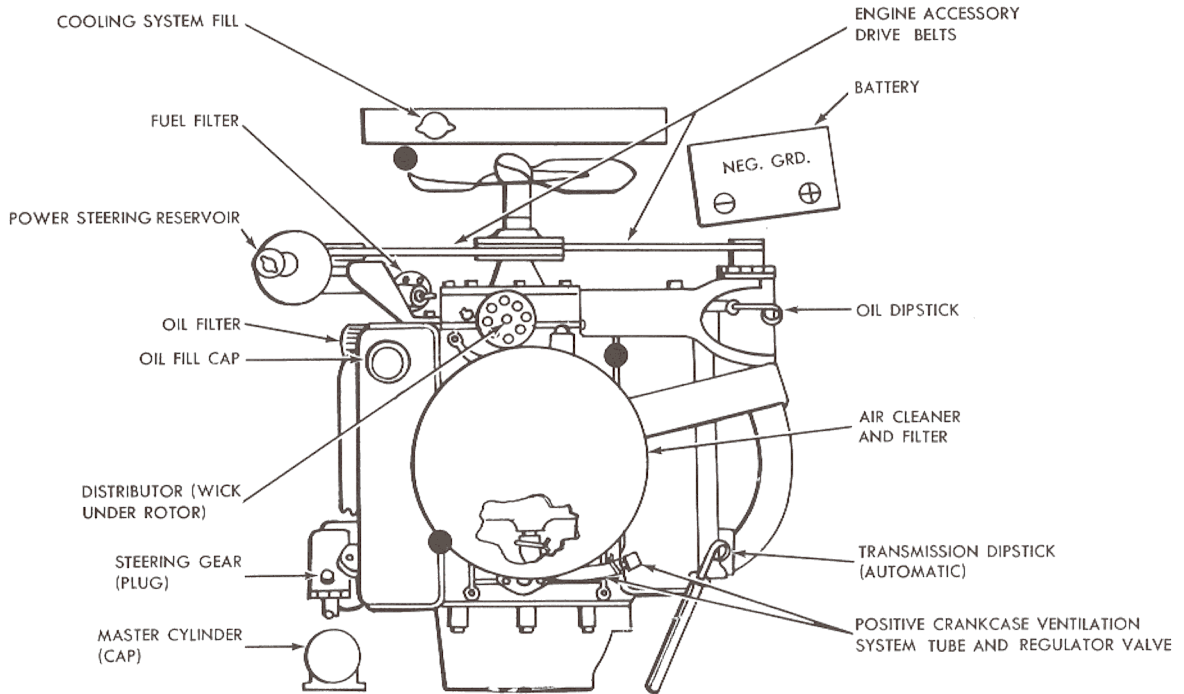

● COOLING SYSTEM DRAIN

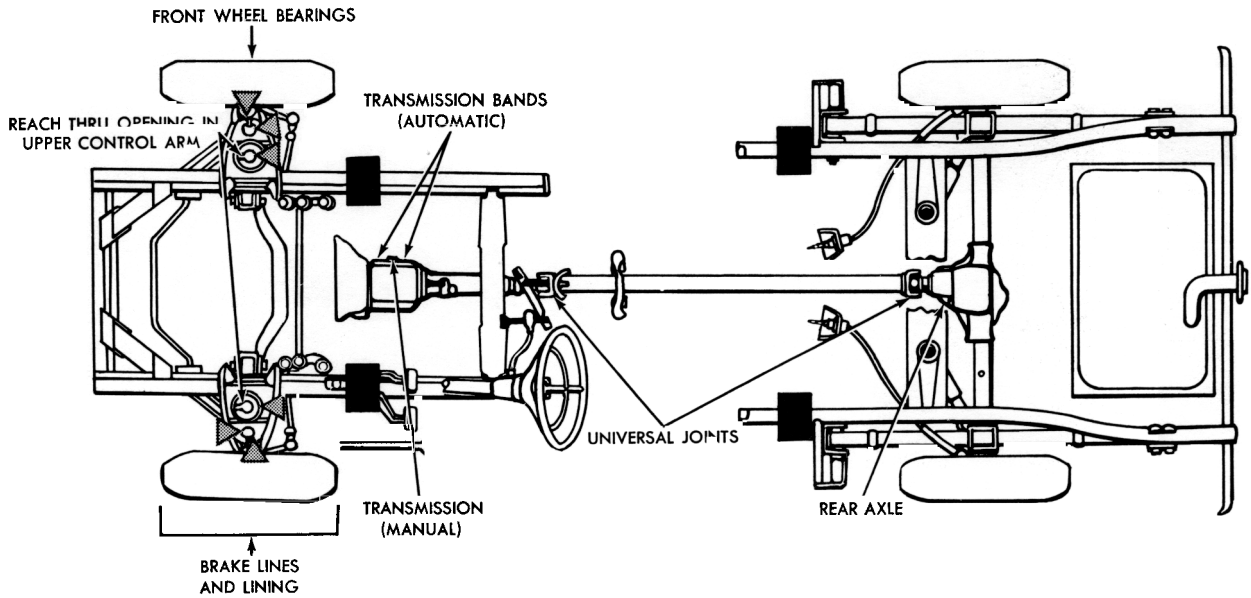

▲ FRONT SUSPENSION

FIG. 2—Typical Lubrication Chart—V-8 Engine